

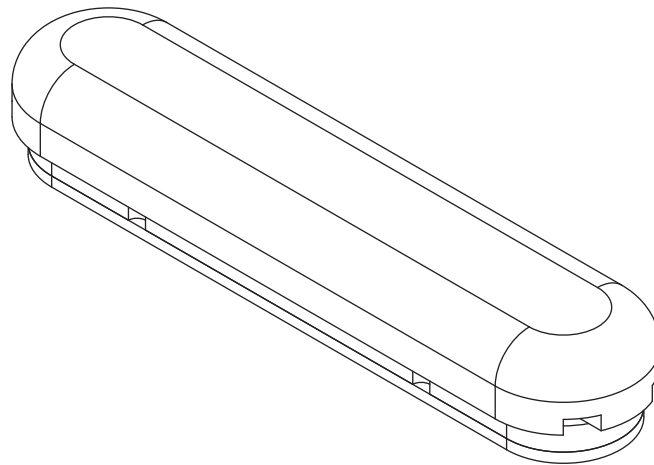

LED Billet

Installation and Maintenance Instructions



IMPORTANT: All wiring connections must be made before switching on mains power.

 G3.2 LED Strip 0.42W 37.5lm per billet

 This product should not be disposed of in your general waste

 Please retain these instructions for future reference

 Class III - Extra Low Voltage

IP40 Indoor Use Only

 European Conformity

Electrical Supply

Installation must be carried out by a qualified electrician in accordance with BS 7671:2008 Wiring Regulations. 230/240V AC 50/60Hz mains supply to a suitable 24V PSU.

Site conditions: LED equipment is more susceptible to static damage and overvoltage than previous technology. Before handling or connecting to the mains supply ensure that all MSL products are protected from static discharge and that the mains supply is to regulation. (230V +10 -6%)

Mains cables must be double insulated, strain relieved and separated from E.L.V output cables.

This unit requires a 24V constant voltage PSU.

Observe polarity:

Positive (+) is marked as RED.

Incorrect supply or reverse polarity can cause irreparable damage.

All connections must be made before switching on mains.

If the supply is energised prior to making the connections to the fitting then the resulting surge will damage the LED.

Multiple LEDs should be wired in parallel, refer to driver instructions for minimum/maximum load.

All lighting equipment is delicate and easily damaged through misuse or inappropriate installation (mechanical or electrical). Repairs and replacements may cause delays and will be chargeable. Contact MSL for support if required. For full warranty terms & conditions please visit our website.

The light source of this luminaire is not replaceable; when the light source reaches its end of life the whole luminaire shall be replaced. Contact MSL if refurbishment is required.

Caution - This product contains magnets. Magnets are dangerous if ingested, can affect pacemakers and other magnetically sensitive equipment.

Installation

Check that the mounting surface is suitable for the installation of this fitting.

Care must be taken when handling this fitting.

Anti-static equipment must be used at all times during installation.

Step 1 Make mains connections to SELV LED driver and extra low voltage connections to the fitting.

Step 2 Mount the billets in place using a suitable adhesive or the attached magnets (if supplied) to secure the fittings to the mounting surface.

WARNING: Do not look at exposed LED lamps in operation. Eye injury can result.

Magnet Mounting

The strength of the magnetic fixing method is dependent on the ferrous content of the mounting surface material. For example mild steel creates a much stronger magnetic fix than when using the same magnets on stainless steel. We suggest that the intended surface is tested to ensure adequate adhesion of the equipment before the selection on mount surface is made.

Galvanised steel building tape or similar can be used as a mounting first fix.

VHB Tape Mounting

To obtain optimal adhesion, the bonding surfaces must be well unified, clean and dry. Clean with a solution of IPA/water mixture (rubbing alcohol).

Cleaning:

Fully isolate the fitting and allow to cool.

Clean with a soft brush only, no solvents or chemicals should be used.

STOANE LIGHTING

EQUIPMENT DESIGN + MANUFACTURE

